

Providence School Building Committee

Capital School Projects Update

December 17, 2024

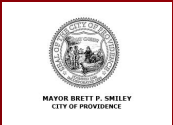

Providence
Schools



Project Update

School Name	Project Budget (Based on Amendments to 2019 & 2022 MOA's)	Student Capacity	Completion Date
Construction			
D'Abate Elementary School	\$22,000,000	365	Occupied
Frank Spaziano Elementary School	\$44,000,000	684	Occupied
George West Elementary School	\$525,000	601	Completed
Pleasant View Elementary School	\$18,109,132	418	Fall 2024
Esek Hopkins Middle School	\$450,000	595	Completed
Nathanael Greene Middle School	\$2,000,000	772	Completed
Classical High School	\$40,278,711	1113	Fall 2025
Hope High School – Phase 1 completed	\$18,000,000	1135	Phase 2 Summer 2024
Narducci Learning Center	\$30,500,000	700	Occupied
Pre-Construction (Phase 2)			
Frank Spaziano Middle School	\$34,500,000	300	Fall 2025
Harry Kizirian Prek – 8	\$55,253,171	729	Summer 2026
Fogarty Prek-8	\$56,575,600	729	Summer 2026
Phase III - Development			
Messer/WBROADWAY Prek-8	\$62,500,000	972 (est)	Summer 2027 (est)
Lima/Stuart Prek-8	\$62,500,000	972 (est)	Summer 2027 (est)
Mt. Pleasant Early Career and College Academy	\$110,000,000	1000 (est)	Summer 2027 (est)
RFK PK-8			

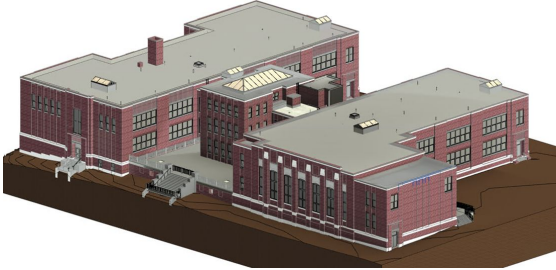

Project Update

Providence Public Schools RIDE Stage II 2024														
Projects						Major Scopes of Work								
School	Size	Grade Levels	# of Classrooms per Grade	# of Students	Budget	New HVAC	Building Envelope (Roof, Windows, etc.)	New Secure Entrance, Security Improvements, Energy Efficiency	ADA Improvements	Restroom Renovations	Educational Enhancements	Interior Finishes	Site Improvements	Fire Marshal Deficiencies
Carnevale	<div>Phase 4 projects are under review and additional updates will be provided at future meetings.</div>													
Delsesto														
Vartan														
New Build @ MLK**														
Hope														
Greene *														
New Build @ Kennedy **														
Roger Williams *														
* Includes a new 10,000 Sq.ft														
** According to RIDE Guideli														
School														
Central														
Leviton														
Bishop														
Alvarez														
Bailey														
PCTA														
E-Cubed														
JSEC														
Young & Woods														
Classical														
Total Revolving Fund														

Groundbreakings and Ribbon Cuttings

Harry Kizirian
PK-8 School

PROJECT SPOTLIGHT

Project Budget: \$55,253,171

Completion Date: Summer 2026



The Harry Kizirian P K-8 school is preparing to be transformed with a budget of \$55,253,171. With construction being imminent this school will be gearing up to welcome 729 students. This project will be providing state of the art spaces that will transform the educational outcomes for these students.

HARRY KIZIRIAN
PK-8 SCHOOL:

Building a Future of Innovation,
Learning, and Community



Building Design:
Three story structure with interconnection to the gym
Separated floors for lower and upper grade students
Learning commons, breakout rooms for group activities and teacher planning



Key Features:
Modern classrooms and specialized resource rooms for high needs learners
Art and STEAM and Music spaces
Gymnasium, full kitchen, cafeteria and media center



Site Enhancements:
New fencing, bus loops and drop off lanes
Modernized play and landscaped areas

Building Futures, Inspiring Learning
A New Era for Harry Kizirian



Providence Schools

 Rhode Island Department of Education







Classical
High School

PROJECT SPOTLIGHT

Completion Date: Fall 2024

Project Budget: \$40,278,711



Classical High, one of the highest performing high school's in the state, has been renovated with a project budget of \$40,278,711. In a multi-phased project, 8 months ahead of schedule, this building has been transformed into an incredible state of the art facility where students are equipped to get the most out of their learning. This school will be supporting 678, 9-12th grade students who have seen the progression of renovations over the past few years and have continuously commented on the stark difference.

CLASSICAL
HIGH SCHOOL:

Building a Future of Innovation,
Learning, and Community



Building Design
Three story structure with preserving some historical parts
Dedicated redesign spaces for different college and career programming as well as a 9th grade academy
Upgraded administration and nurses areas



Key Features
College and career dedicated spaces
Modernizing media center and administration area
Updating building security and furniture





Innovative Technology
21st Century Media Space
Modern classrooms and specialized resource rooms for high needs learners

Building Futures, Inspiring Learning
A New Era for Classical High School



Providence Schools

 Rhode Island Department of Education







Providence
Schools



MARY E. FOGARTY ELEMENTARY SCHOOL
PRE K - GRADE 5 | 3 TRACK
GRADE 6 - GRADE 8 | 4 TRACK



LEGEND

	ACTIVE LAB
	LEARNING STUDIOS
	LEARNING COMMONS
	SHARED SPACES
	CAFETERIA / GYM
	MEDIA CENTER
	ADMINISTRATION
	ART / RESOURCE / TECH / STAGE
	WELLNESS SUITE
	PLAYGROUND
	SERVICE

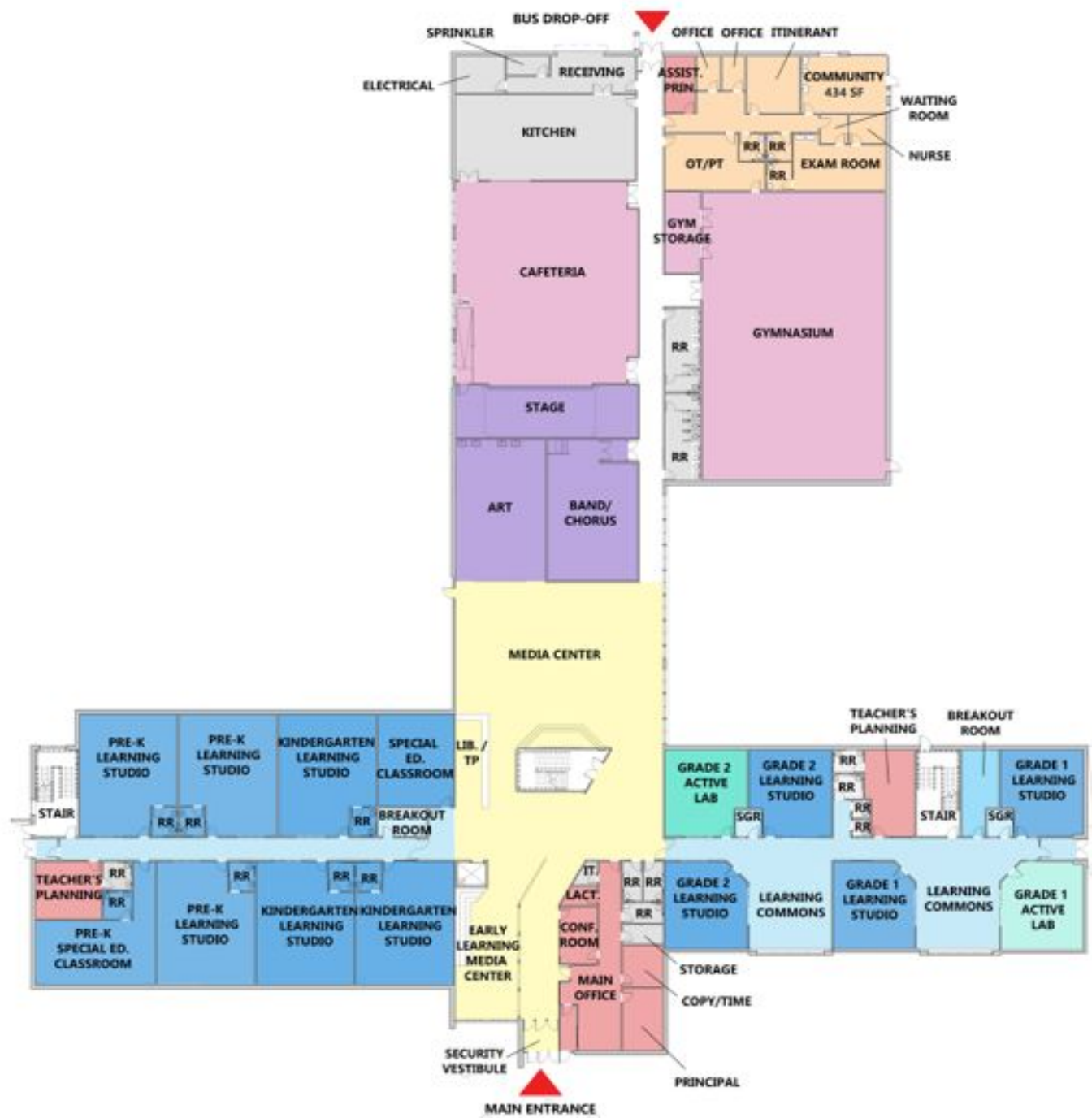

Ground Floor

LEGEND

ACTIVE LAB
LEARNING STUDIOS
LEARNING COMMONS
SHARED SPACES
CAFETERIA / GYM
MEDIA CENTER
ADMINISTRATION
ART / RESOURCE / TECH / STAGE
WELLNESS SUITE
PLAYGROUND
SERVICE

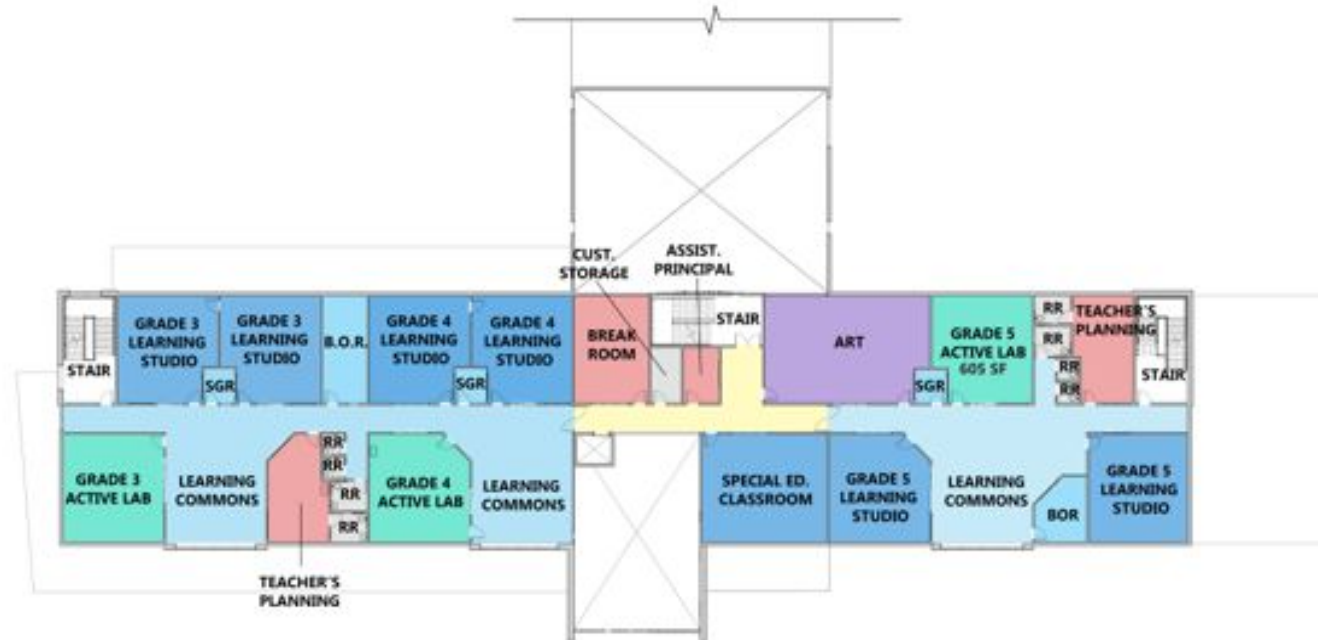

Second Floor

LEGEND



- ACTIVE LAB
- LEARNING STUDIOS
- LEARNING COMMONS
- SHARED SPACES
- CAFETERIA / GYM
- MEDIA CENTER
- ADMINISTRATION
- ART / RESOURCE / TECH / STAGE
- WELLNESS SUITE
- PLAYGROUND
- SERVICE

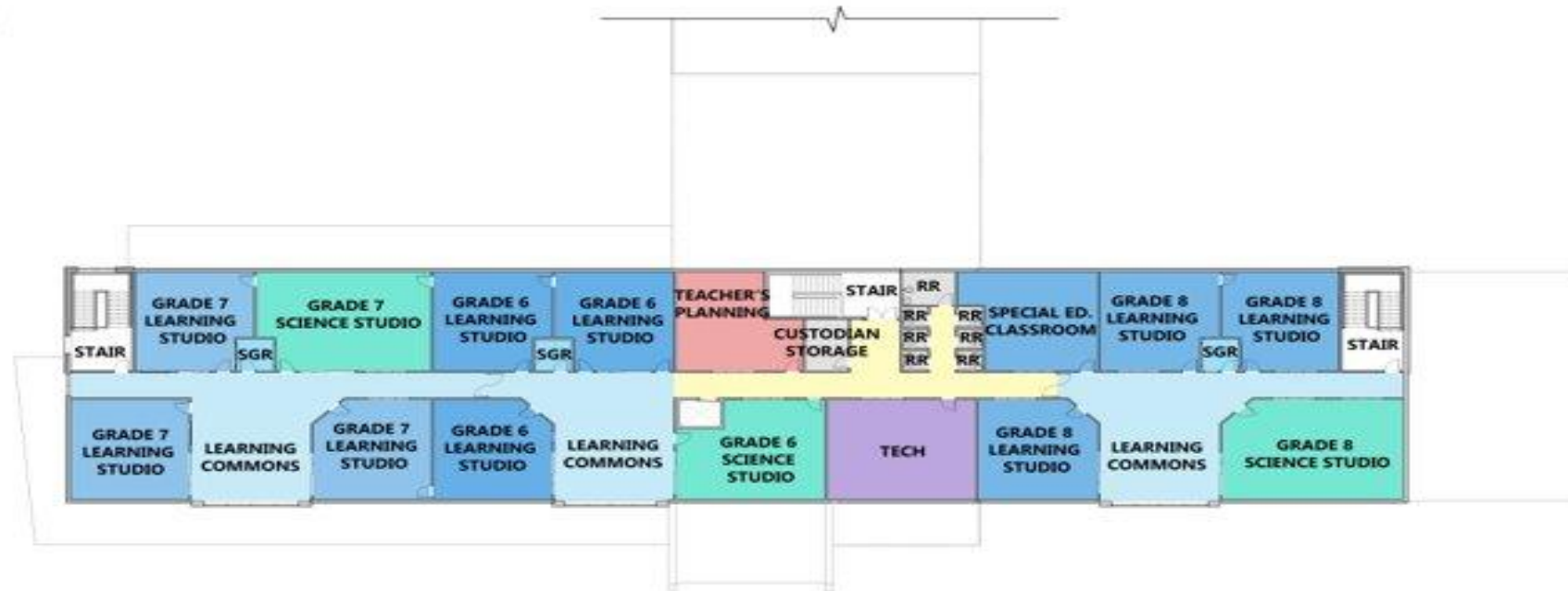

Third Floor



Providence
Schools



DOWNES
CONSTRUCTION COMPANY

MARY E. FOGARTY ELEMENTARY SCHOOL
PRE K - GRADE 5 | 3 TRACK
GRADE 6 - GRADE 8 | 4 TRACK



Groundbreakings Fogarty



MAIN ENTRANCE



COMMUNITY ENTRANCE



Classical HS – Renovations



New High Density Shelving Storage



Library Breakout Room



New Admin Furniture



Providence
Schools



- Administration Office to be completed October 2024
- Construction Complete October 2024
- Lockers and new bookshelves to be delivered by end of 2024
- Move into new Media January 2024

New Kizirian PK-8



Providence
Schools



DOWNES
CONSTRUCTION COMPANY



STUDIO
JAED



DIMEO

New Kizirian PK-8

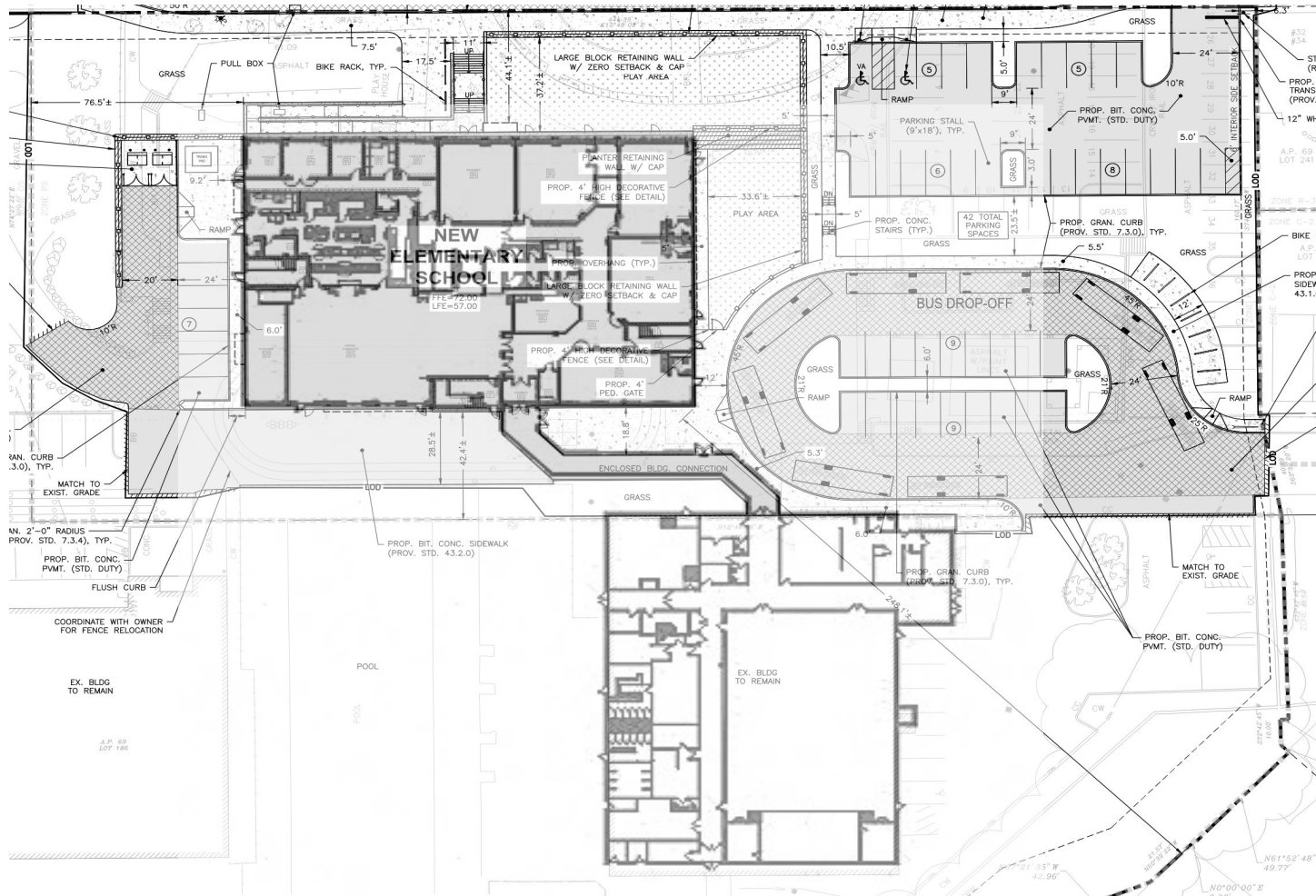

Proceeding with Existing Gym Option
Contractor procuring pricing for GMP
Project submitted to RIDE portal



Providence
Schools



DOWNES
CONSTRUCTION COMPANY



STUDIO
JAED



DIMEO

Spaziano 6-8 Middle School

Providence
Schools

Tecton
ARCHITECTS



100% Construction Documents – Site Plan



North



PLANT SCHEDULE						
CATEGORY	SYN.	REL.	BOTANICAL NAME	COMMON NAME	SIZE	CONT.
DECIDUOUS TREES	AP	2	ACER X FRIEDLANDI 'ARMORCHES'	ARMSTRONG RED MAPLE (FRIEDLAND)	2" x 1 1/2" DAL	800-5 MML BRANCHING HEIGHT
	CR	2	CARPENUS BETULUS 'FARTIGATA'	FARTIGATA EUROPEAN HORNBEAM	2" x 1 1/2" DAL	800-5 MML BRANCHING HEIGHT
	GR	4	QUERCUS BILBOA 'AUTUMN GOLD'	AUTUMN GOLD HAWTHORN TREE	2" x 1 1/2" DAL	800-5 MML BRANCHING HEIGHT
	OR	4	QUERCUS BILBOA 'WAGON'	COLUMBIAN WAGON WHITE OAK	2" x 1 1/2" DAL	800-5 MML BRANCHING HEIGHT
	UK	3	ULMUS AMERICANA 'PRINCETON'	PRINCETON AMERICAN ELM	2" x 1 1/2" DAL	800-5 MML BRANCHING HEIGHT
SHRUBS	RD	5	ILEX GLABRA 'SHARROCK'	SHARROCK HOBBOCK	36" x 36" SP.	CONTAINER
	RP	5	RHODODENDRON 'YAKU PRINCE'	YAKU PRINCE RHODODENDRON	18" x 36" HT.	CONTAINER
GROUNDCOVER	EF	400	EUCHORIS FORTUNEI 'SOLARATUS'	PURPLE WINTERGREEN	1 GAL.	CONTAINER 12" SPACING

Tecton
ARCHITECTS



APPROVED PLAN MODIFICATIONS

Providence
Schools

Tecton
ARCHITECTS

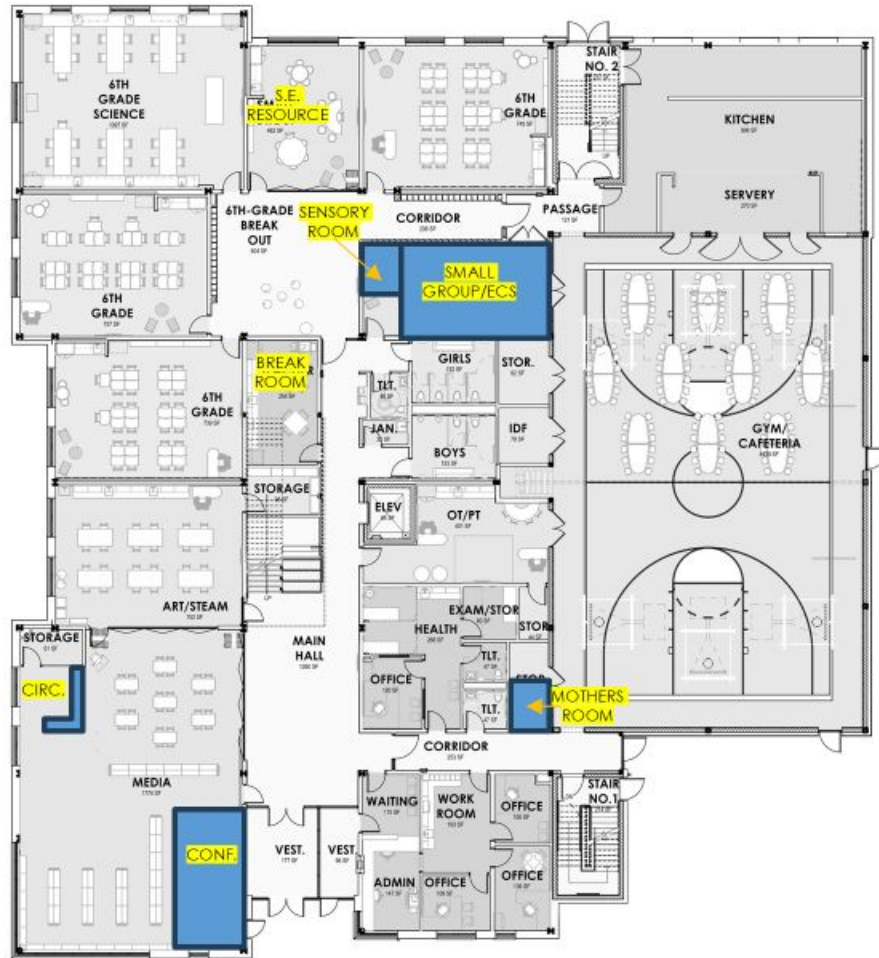

Main Level

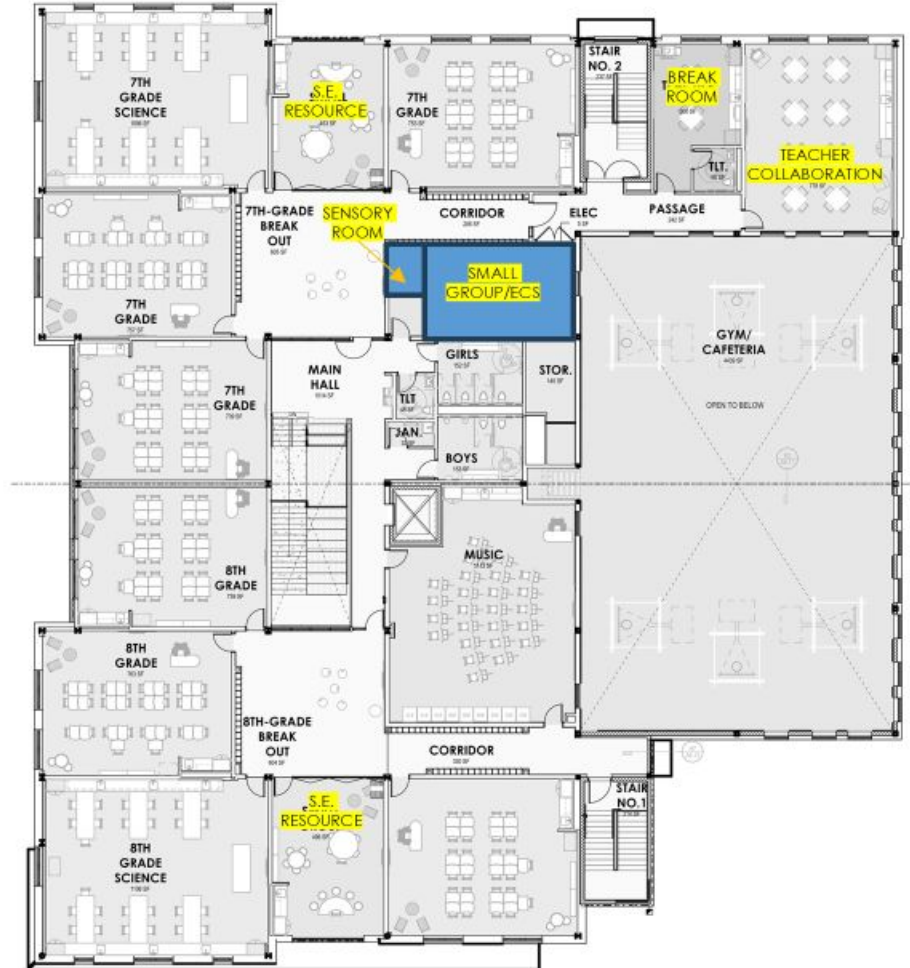

Upper Level

UPDATED FLOOR PLANS

Providence
Schools

Tecton
ARCHITECTS

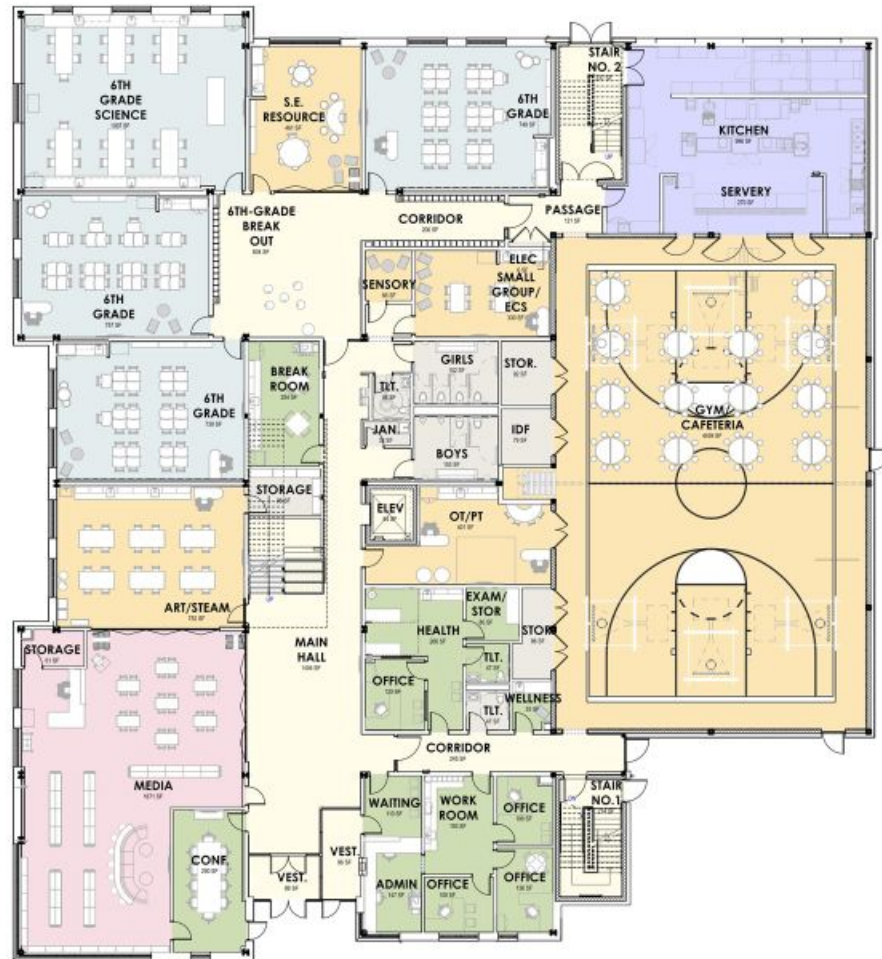

Main Level



Upper Level

Groundbreakings Spaziano MS





Mount Pleasant Early College and Career Academy: **PLANNING CONCEPT 'A'**

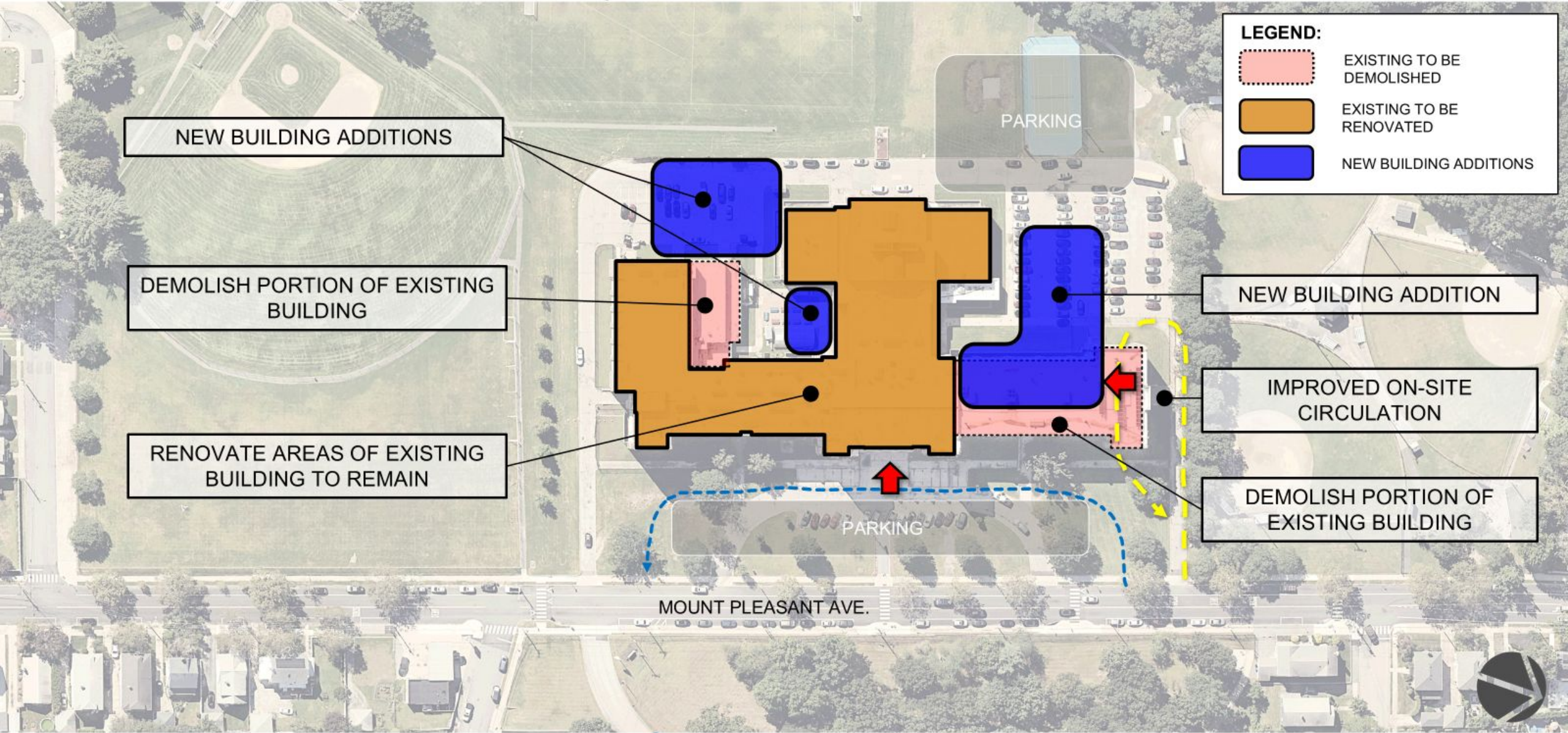

Mount Pleasant Early College and Career Academy: **PLANNING CONCEPT 'B'**

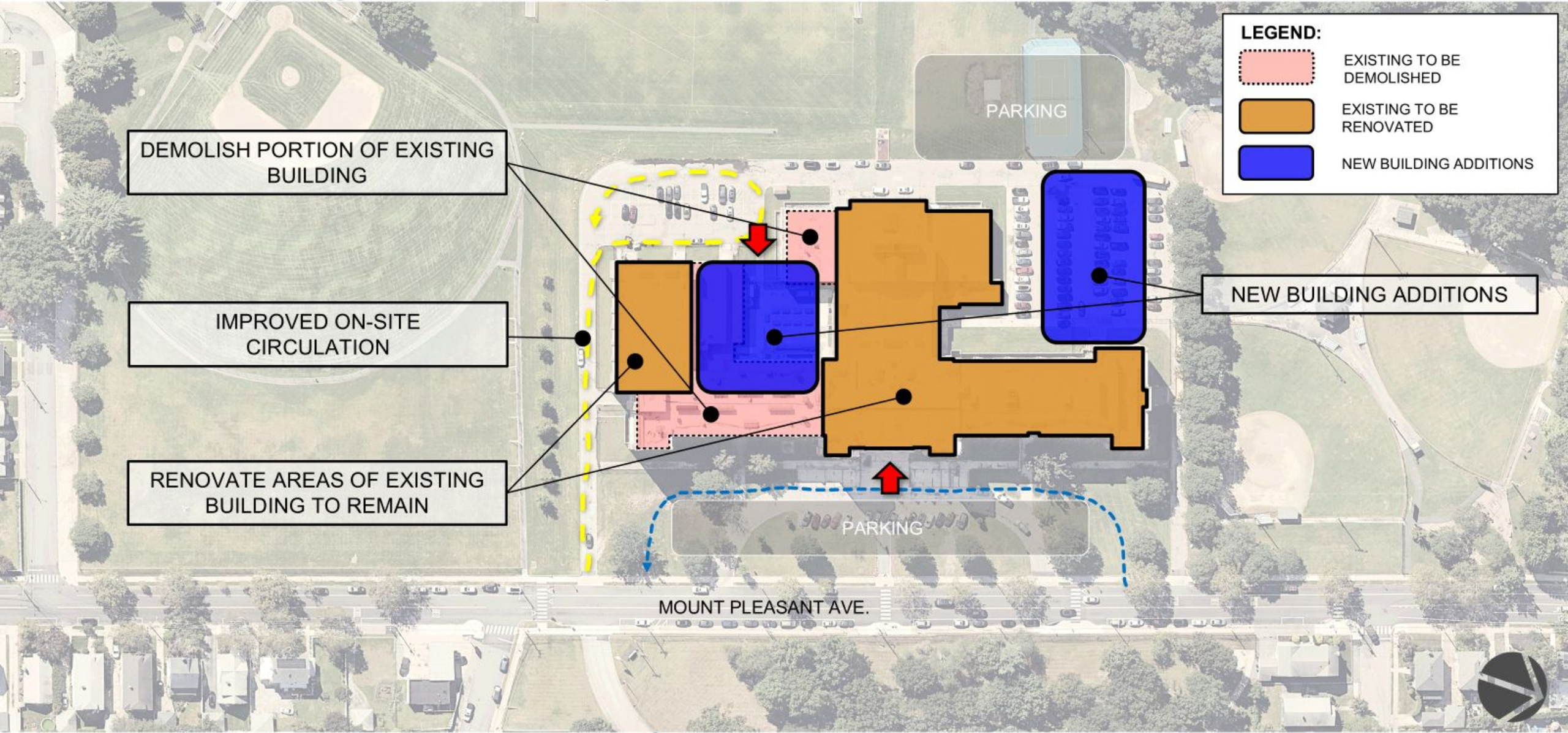

Educational Visioning Workshops

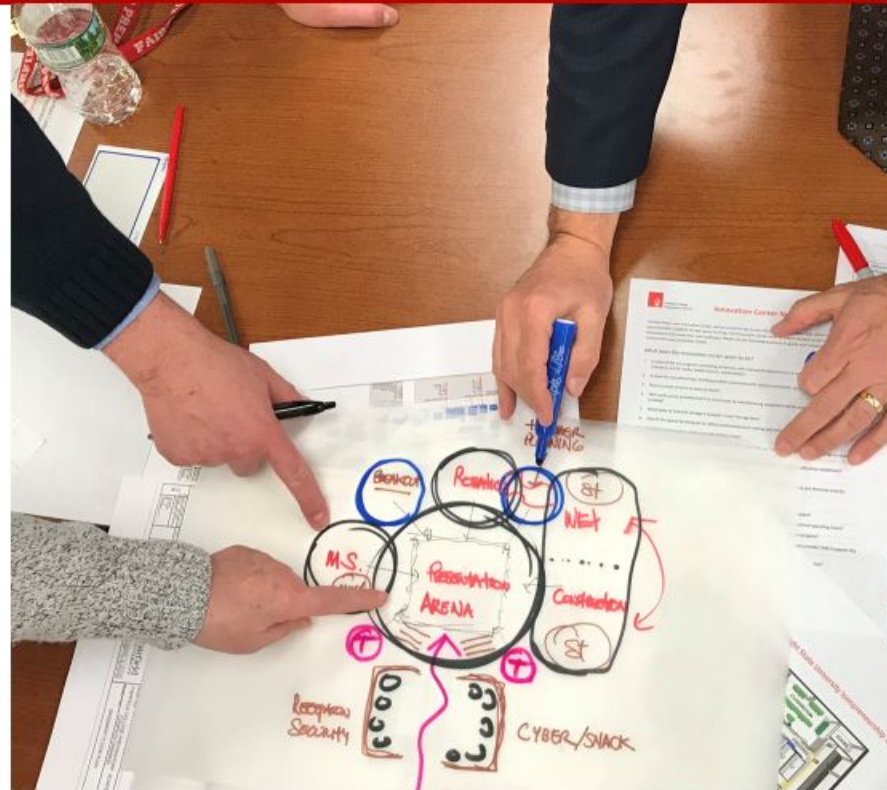

MAYOR BRETT P. SMILEY
CITY OF PROVIDENCE

Providence
Schools



PERKINS
EASTMAN

Mount Pleasant Early College and Career Academy Educational Visioning Workshop Overview

Providence Phase 3 School Construction - \$110 Million

To further refine the Mount Pleasant Early College and Career Academy (MPECCA) Stage 2 proposal developed by the Rhode Island Department of Education (RIDE), four Educational Visioning Workshops will be conducted by My Learning Place Integrated Design (MLPID). These workshops will foster collaborative discussions to shape the vision for MPECCA

The Mount Pleasant High School community and the School Building Committee (SBC) key stakeholders may include the following:

- Mount Pleasant High School administrators
- Teachers
- Building committee members
- Students
- Parents
- Community partners

Visioning Review

School Tours

Visioning 1

Workshop 1

Visioning 2

Workshop 2

December 2024

February 2025



MAYOR BRETT P. SMILEY
CITY OF PROVIDENCE

Providence
Schools

D
DOWNES
CONSTRUCTION COMPANY



**PERKINS —
EASTMAN**

Action Item